



## Yuasa Technical Data Sheet

### Yuasa 12N9-4B-1 - Conventional 12 Volt Battery

#### Performance

Voltage	12
Capacity (10-hour)	9Ah
Capacity (20-hour)	9.5Ah
CCA @ -18°C	85A

#### Dimensions (±2mm)

Length	135mm
Width	75mm
Height	139mm

#### Weights & Measures

Mean Weight with Acid	3.2kg
Acid Volume	0.6l

#### Technology

Technology	Cast Sb/Sb
Separator	Synthetic Resin+Glass Fiber



#### Cell Assembly Layout

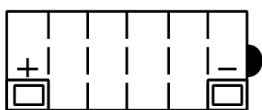

#### Terminal Type - 6

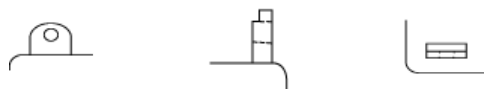

Data Sheet generated on 05/02/2023 - E&OE